



SMART LAMINATOR

user manual

Thank you,

For selecting the pouchjet® pro II DIN A3 professional laminator.
We wish you success and enjoyment while using your new laminator!

Insert, set, and your're off!



1.	Description of components	3
2.	Safty guide and conditions for use	3
3.	What can you laminate with your pouchjet® pro II	4
4.	Automatic detection of protection grade	4
5.	Laminating	6-7
6.	How to insert the pouches	8
7.	Attention!	9
8.	Advice for your next lamination project	10
9.	Troubleshooting	11

1 Description of components

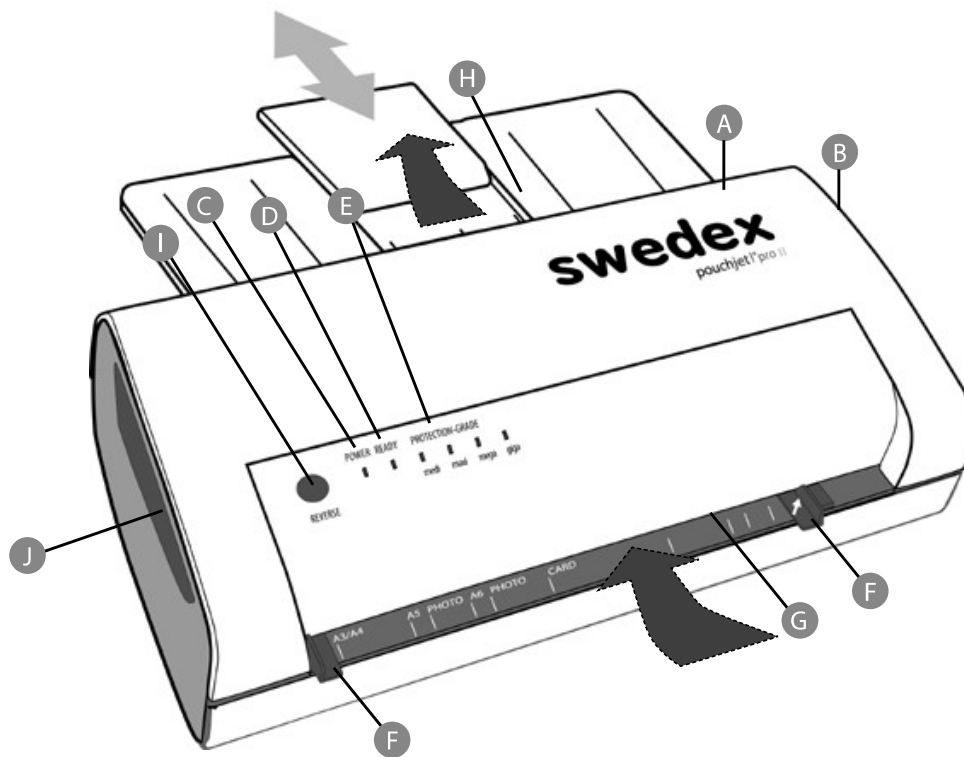

- A power cord, on the back of the machine
- B power switch, on the right side of the machine
- C POWER LED (red when on)
- D READY LED (flashing green while the machine is heating up and then constant when ready)
- E Automatic display of protection grade
- F Adjustable slider for format width (manual)
- G Entry slot
- H Material exit, on the back of the machine
- I REVERSE switch in case of a jammed pouch
- J Grips

2 Safty guide and conditions for use



This machine is intended for laminating paper and paper-like materials, and was specially designed only for this purpose. Please use the laminator only for this purpose and in the way that is described in the user manual.



Do not stick or insert any other objects into the openings in this machine besides the materials recommended in this guide.



Attach the power cord so that it is not bent, crimped or twisted. Please also take care that no damage will occur to the plug or the cord.



Protect the machine from dampness and water! Do not use the machine if the power cord or plug show signs of damage. If the laminator is not in use or you would like to clean it, please pull out the power cord beforehand.



Keep this machine out of direct sunlight. Do not place it near a heater or air conditioning unit (see illustration below). Do not place or set any objects on top of the machine. Please let the machine cool down before cleaning.



In case of a malfunction, please do not attempt to repair the machine yourself. If repair is necessary, contact the manufacturer.



For reasons of safety, we recommend unplugging the machine after use.



Please keep this manual with the machine case of reselling or transferring it to another party.



Install the laminator near to a socket-outlet wich is easy accessible.

Attention:



To avoid risk of electric shock, under no circumstances open the laminator's cover (the housing cover). It does not contain any parts that can be repaired by the user. Repair work may only be performed by qualified professionals.



Never open the housing of the machine or touch any of the parts that are only meant to be used by technical support staff.



Do not open the machine – this will result in the voiding of any warranty claims.

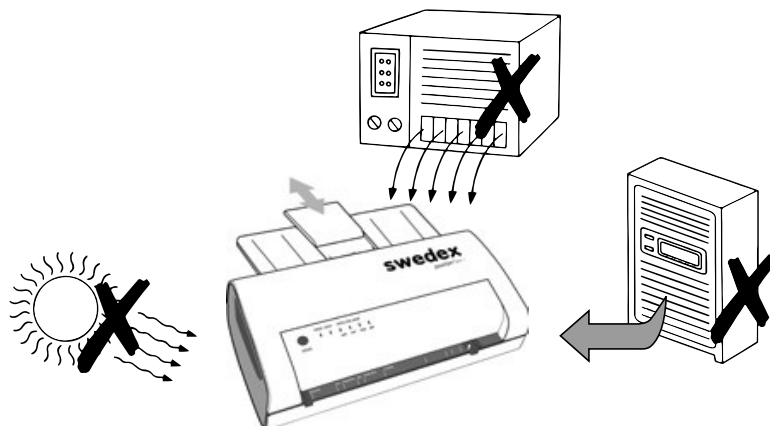

3 What can you laminate with your pouchjet I® pro II

You can use your pouchjet® pro II to laminate common printable types of paper, photocopies, laser and inkjet printouts, photographs or layered inkjet and laser printouts up to a thickness of 1 mm (pouch plus document to be laminated).

4 Automatic detection of protection grade

Automatic detection of protection grade

Your pouchjet® pro II will recognize the type of smartpouch that you have inserted and then will set the optimal laminating speed and optimal laminating temperature automatically.

If you are using a smartpouch with grade mini, the machine will show a green light on all grade indicators.

Attention!

Please use only the pouchjet® pro II specifically designed for use with the smartpouches that have the protection grades turbo, medi, maxi, mega or giga. The use of these pouches will ensure the full functionality of your laminator.

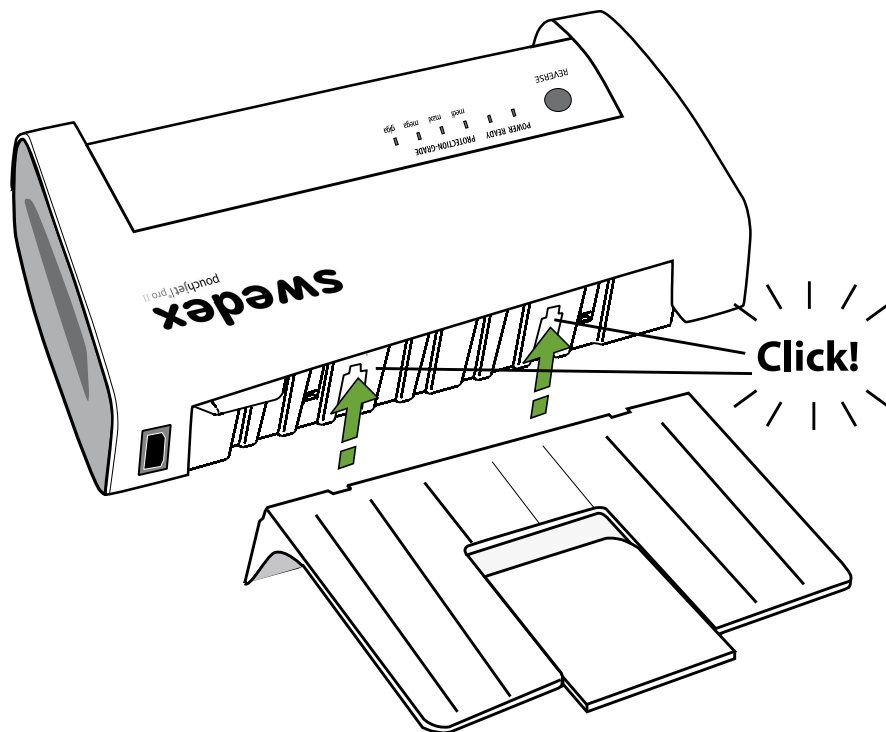

5 Laminating

1. Preparation

Use the grips **J** the sides of the laminator pouchjet® pro II to place it on a smooth and level surface close to a power socket **(Fig. A)**.

Make sure to leave enough space behind the machine to allow for a smooth exit of the laminated product from the machine as well as easy collection **(Fig. B)**. Plug the power cord **A** into the socket and press the power switch located on the right side of the machine **B**.

The red "POWER" LED **C** will light and the green "READY" LED **D** will flash **(Fig. C)**.

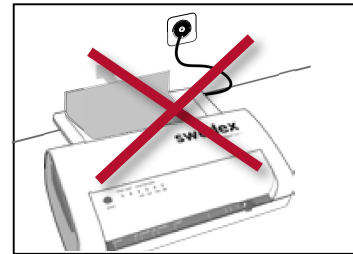

Fig. A

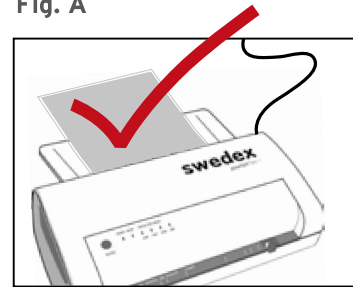

Fig. B

2. Readiness to operate and setting the format

Wait until the "READY" light **D** displays a constant green. The laminator is now ready to operate.

Adjust the slider **F** to match your document's format.

Please note, the sliders **F** move parallel to each other! **(Fig. D)**

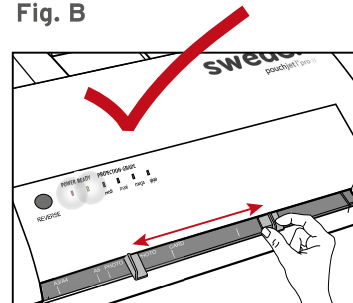

Fig. C

3a. Sliding the document into the smartpouches

Select the proper laminating pouch size for your document.

Important! Place the document into the smartpouch, so that the edge touches the sealed side of the pouch **(Fig. E)**.

This will produce excellent lamination results. (Avoids paper jams!)

The smartpouches are sealed along the long side, which will make positioning your documents considerably more convenient. The document to be laminated should be positioned so that there is an overlap on the non-sealed sides of about 3 mm that can be closed around it **(Fig. E)**.

NOTE! The pouches must be aligned to the right slider (Fig. D).

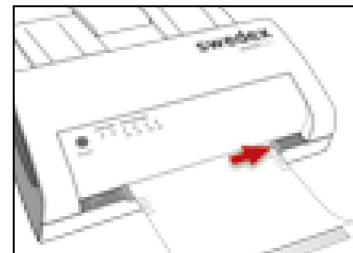

Fig. D

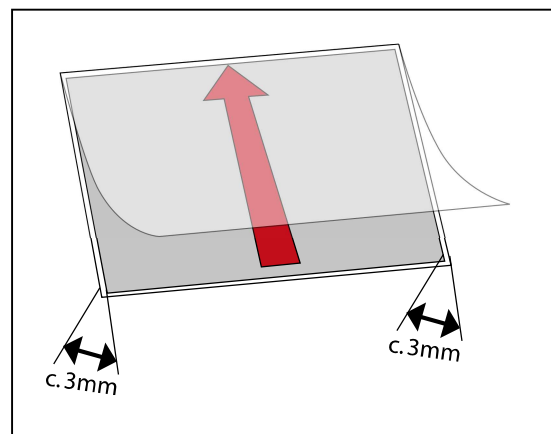

Fig. E

4. Starting the laminating process

Important! Lamination will seal the material you want to laminate permanently. If you are not sure, test the process beforehand using a similar material. Never attempt to pull the laminating pouch out of the machine before the laminating process has been completed.

Important! Now guide the smartpouch starting with the sealed side into the correctly adjusted entry slot **G**. Be sure to use the slider on the right side as a guide for alignment (see the arrow marking on the slider) **F**! (**Fig. F**)

The pouchjet® pro II will detect the protection grade **E** of the smartpouches and will automatically adjust for the optimal settings. The automatic display **E** shows the protection grade.

The pouches thickness will light up on the display.

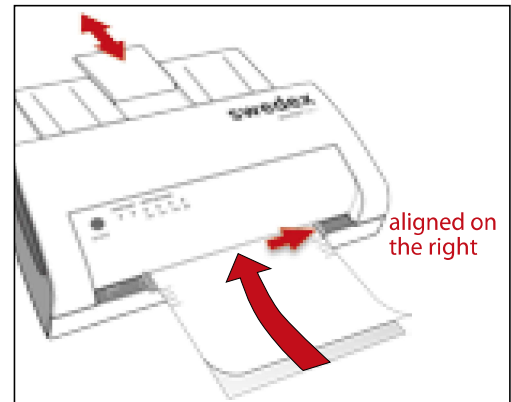

Fig. F

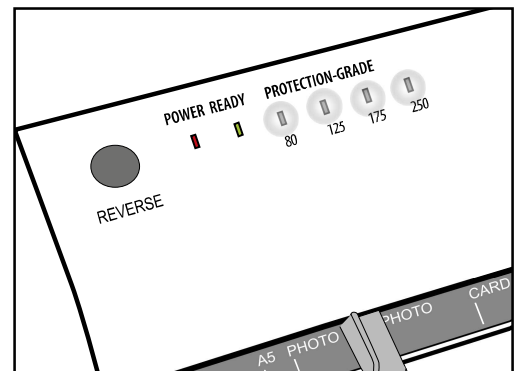

Fig. G

If you choose a turbo pouch, all lights of protection grade **E** will light up (**Fig. G**). The smartpouch is taken in through the laminator and is then automatically pushed on out of the material exit **H** on the back of the machine.

In the event that you are not using authentic smartpouches, your laminator will automatically detect the unknown pouch and eject it. This is done to ensure that the document you have already inserted is not damaged and that the functionality of your pouchjet® pro II remains unimpaired.

Now take the laminated document and allow it to cool by placing it on a table or other smooth and cool surface for about a minute or so. If you do not wish to laminate any other documents at this time, turn the machine off.

After 30 minutes of nonuse, the machine will turn off automatically.

Note!

It is possible that the READY display **D** flashes during the laminating process. This is perfectly normal and will not influence the quality of lamination. If you would like to laminate further documents, simply wait until the READY display **D** is lit constantly again.

6 How to insert the pouches

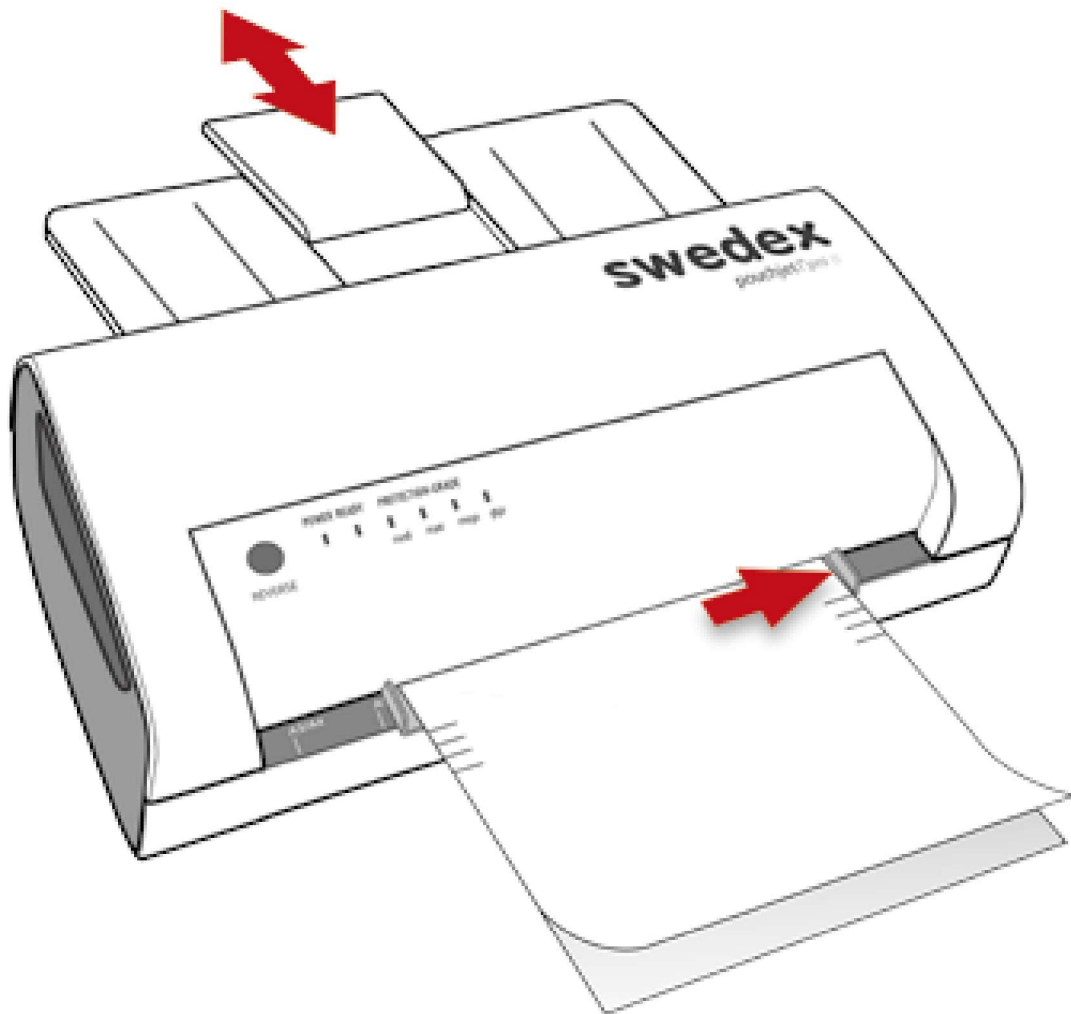

Attention! PLEASE NOTE!

The pouches must be aligned to the right slider!

7 Attention

Attention!

**Please only laminate paper or paperlike materials!
The wrong types of material will destroy the machine!**

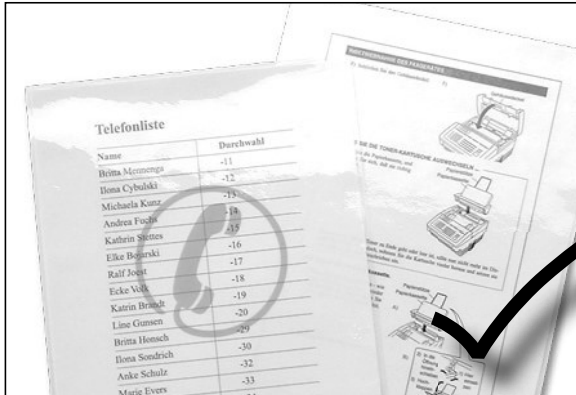

Please only laminate the entire surface and in the correct pouch format!

DO **NOT** laminate:

- things that are heat-sensitive, such as thermal paper for fax machines, tickets with magnetic strips, phone or credit cards. These items can be damaged by the heat and may then be unusable afterwards.
- sharp objects or materials that are thicker than 0.6 mm. This may damage the rollers.
- damp or wet objects or items that contain liquid. The liquid may leak and damage the machine.

8 Advice for your next lamination project

Please pay attention to the following points when working with the pouchjet® pro II.

Never cut a smartpouch, before laminating it (**Fig. I and Fig. II**). Cut smartpouches get stuck in the machine.

Do not use two smartpouches in combination in order to increase the area of the surface to be laminated (**Fig. III**). They may be caught in the laminator.

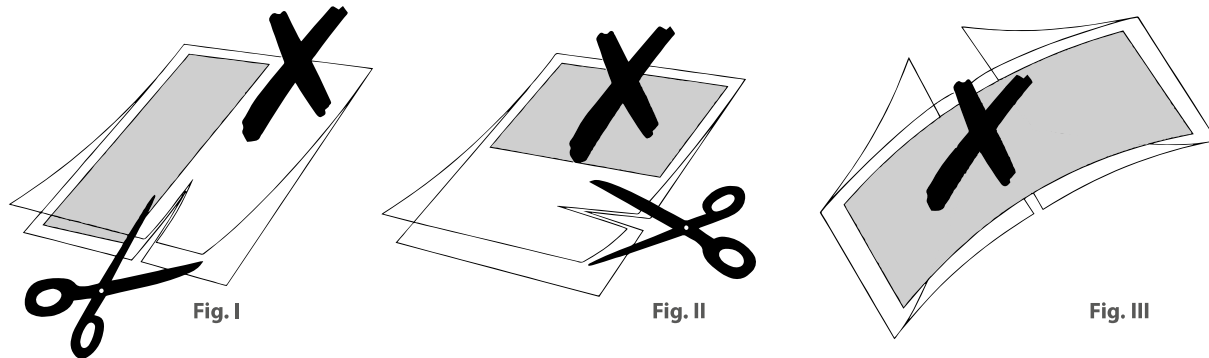

The double-layered smartpouches are sealed on one side. Please do not try to separate the layers in order to use only a single laminating page for lamination.

Always use a complete laminating pouch and always insert it into the machine sealed side first.

Do not laminate empty smartpouches.
Otherwise, the laminating film could get trapped in the machine.

Please insert a new document for lamination into the pouchjet® pro II only after the previous document has been completely fed out of the machine. This will prevent documents from overlapping and damaging the machine.

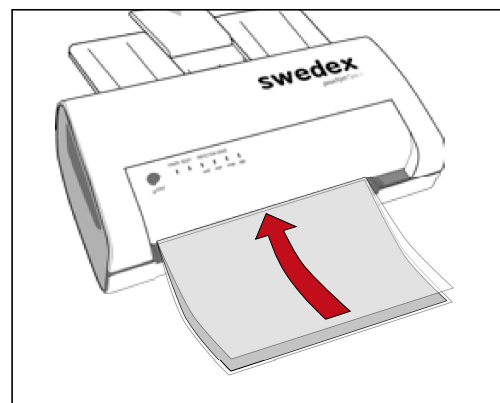

9 Troubleshooting

A smartpouch is stuck in the machine.

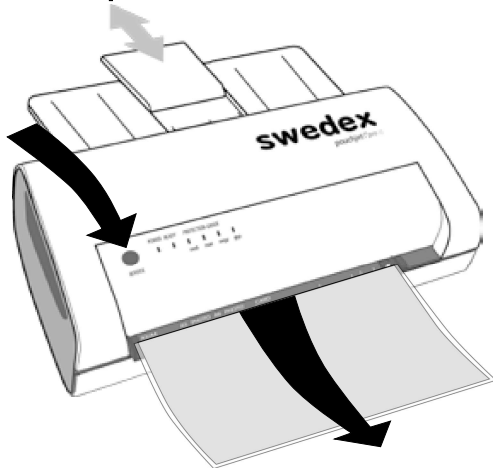

Should this happen, press the REVERSE switch **I** (reverse button). The smartpouch will automatically be transported backwards out of the machine.

Remove the pouch from the entry slot **G**.

If the smartpouch cannot be removed, turn the machine off and contact customer service immediately.

Maintenance and care

Please unplug the power cord from the socket before starting to clean the machine's outer housing. Then clean the machine's housing with a dampened, soft cloth and neutral (mild) household detergent. Take care not to use a cloth that is too damp and to prevent moisture from entering the machine

Technical specifications

Measurements (width x depth x height): **473 x 237 x 140 mm** (18.6" x 9.3" x 5.51")

Maximum laminating width: **320 mm** (12.5")

Maximum laminating thickness: **1,0 mm** (0.04")

Possible protection grades: **turbo, medi, maxi, mega, giga**

Possible formats: **A3 / A4 / A5 / A6 / Card / Photo 9x13mm / 10x15mm menu size (12"x18") / legal size (9"x14.5") / letter size (8.5"x11") / OBT (6"x9") / key card (2.5"x3.875") / luggage pouch (2.5"x4.25")**

Laminating speed: **max. 60mic / 2200mm** (max. 2.5 mil/86.6")

Operation method: **8 rollers**

Heating system: **4 heated rollers**

Time form preheating: **55 sec.**

Automatic turn-off time: **after 30 min.**

Power supply: **220-240 V / 50-60 Hz** (110-120 V / 60 Hz)

Power consumption: **1750 W / 7.6 A** (14.6 A)

Weight: **5.2kg** (11.7 lb)



Technical requirements are subject to change.